

# HUSHCORE™ DECK™ SYSTEM, MODEL DS-53, IN-CURB ACOUSTICAL TREATMENT FOR CURB MOUNTED RTU EQUIPMENT

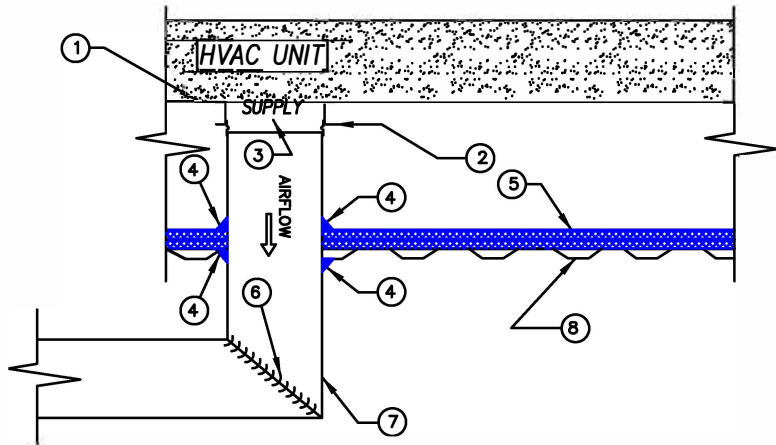

RTU NOISE REDUCTION SYSTEM

BY RTU UNIT MANUFACTURER

1. RTU BASE
2. RTU OPENING
3. INTEGRAL CURB DUCT SUPPORT

BY ACOUSTICAL MANUFACTURER

4. HUSH SEALANT™ ACOUSTICAL GRADE CAULK AT ALL DUCT DROPS & CURB PERIMETER
5. HUSHCORE™ DECK™ SYSTEM, MODEL DS-53 IN-CURB ACOUSTICAL TREATMENT

BY HVAC CONTRACTOR

6. TURNING VANE
7. DUCT WORK
8. ROOF DECK FLASHED TO WITHIN 1/4" OF ALL DUCT DROPS BUT NOT IN CONTACT WITH DUCT WALL
9. SUBMIT LETTER OF CERTIFICATION FROM ACOUSTICAL SUPPLIER FOLLOWING INSPECTION

1. HUSHCORE™ DECK™ System Model DS-53 shall be a multi-layered acoustical composite for placement inside rooftop equipment curbs.
2. Field installed by contractor
3. The overall installed thickness of the composite panels shall not exceed 10".
4. The composite panels shall get HUSH SEALANT™ model HSAC-100 acoustical grade caulk at seams and perimeter edges inside the curb.
5. Decking shall be maintained inside the RTU roof curb to a clearance of 1/4" maximum around all duct drops but never contact the duct.
6. Model DS-53 not suitable for plenum curb application. Plenum curb application shall use Model DS-49
7. A letter of certification shall be issued by the acoustical system supplier stating the complete system has been properly installed prior to setting the units. Photo verification is acceptable for review and approval.
8. Products and systems shall be by BRD Noise and Vibration Control, Inc., Wind Gap, PA - (610) 863-6300, www.HUSHCORE.net.

PERFORMANCE

1. The HUSHCORE™ System shall be supplied by the rooftop unit manufacturer as part of a complete package to assure optimized acoustic performance and proper integration and coordination of the final installation.
2. HUSHCORE™ DECK™ System Model DS-53 In-Curb Acoustical Treatment Performance shall be tested in accordance with procedure ASTM E-90-10. The in-curb composite panel assembly shall be rated at not less than the 1/3 octave performance values as listed below for sound radiation through the deck inside the curb.

HUSHCORE In-Curb Composite - (Transmission Loss) in accordance with ASTM E-90-10																					
Freq. (Hz)	80	100	125	160	200	250	315	400	500	630	800	1K	1.25K	1.6K	2K	2.5K	3.15K	4K	5K	6.3K	8K
Transmission Loss (dB)	26	29	30	32	36	41	46	51	55	57	60	61	64	65	65	65	69	72	74	73	75