

# HUSHCORE™ **BASE™** SYSTEM MODEL **HIR-2** VIBRATION ISOLATION RAILS FOR CURB MOUNTED ROOFTOP UNITS

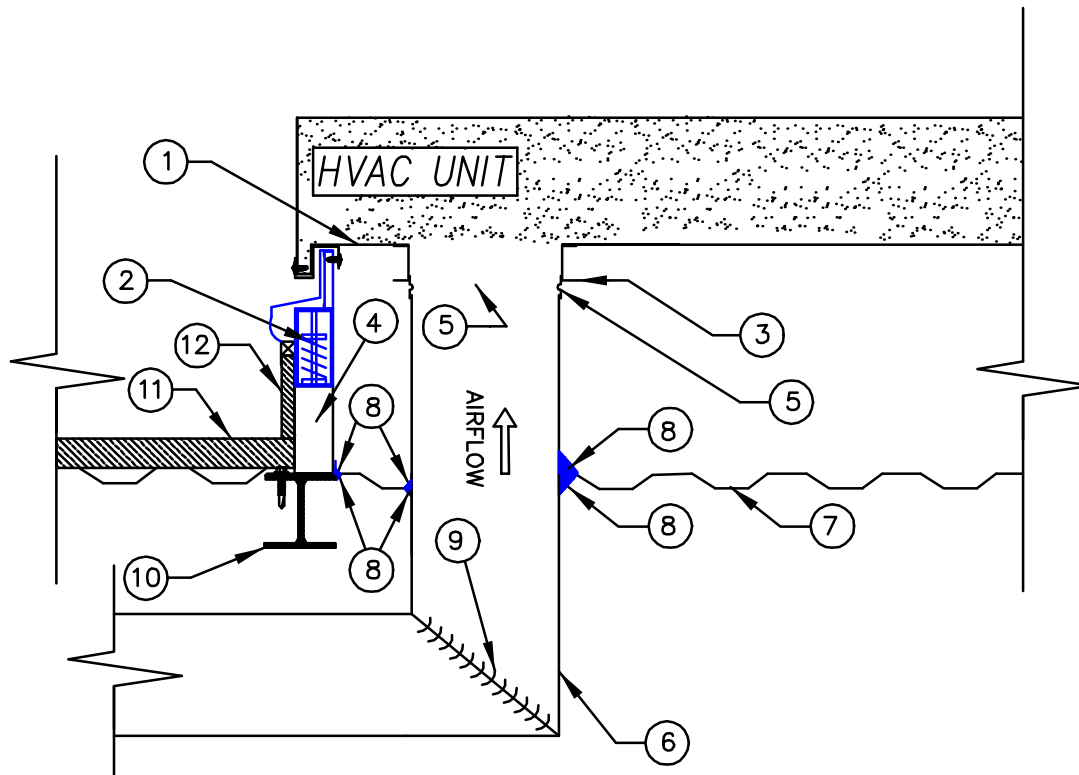

## BY RTU UNIT MANUFACTURER

1. RTU BASE
2. **BASE™** MODEL HIR-2 VIBRATION ISOLATION RAIL CURB
3. INTEGRAL CURB DUCT SUPPORT
4. FACTORY BASE CURB
5. RTU OPENING

## BY HVAC CONTRACTOR

6. DUCT WORK
7. ROOF DECK FLASHED TO WITHIN 1/4" OF ALL DUCT DROPS BUT NOT IN CONTACT WITH DUCT WALL
8. HUSH SEALANT™ ACOUSTICAL GRADE CAULK AT ALL DUCT DROPS & CURB PERIMETER
9. TURNING VANE

## BY GENERAL CONTRACTOR

10. BUILDING STEEL
11. BUILT-UP ROOF OR CONCRETE
12. INSULATION AND CANT STRIP

## RTU NOISE REDUCTION SYSTEM

HUSHCORE™ **BASE™** System Model **HIR-2** shall be a 2" deflection, fully adjustable and fully assembled rail curb system that sits on top of a factory curb (by others). The rail curb assembly shall be a continuous flexible weatherseal. The system shall be capable of serving as a blocking device during installation. The springs shall have built-in limit stops to snub out wind resistance. The **HIR-2** rail curb shall be 13" high and be shipped completely assembled. There shall be removable access ports at each spring location. HUSH SEALANT™ Model HSAC-100 acoustical grade caulk shall be used around all roof deck openings as detailed above after decking is flashed to within  $\frac{1}{4}$ " without contacting the duct wall. Products and systems shall be by BRD Noise and Vibration Control, Inc., Wind Gap, PA - (610) 863-6300, [www.HUSHCORE.net](http://www.HUSHCORE.net)

## PERFORMANCE

The **BASE™** System Model **HIR-2** shall provide minimum 85% vibration isolation efficiency.