

HUSHCORE™ **BASE™** MODEL **NIC** NON-ISOLATED CURB FOR INTERNALLY ISOLATED CURB MOUNTED ROOFTOP UNITS

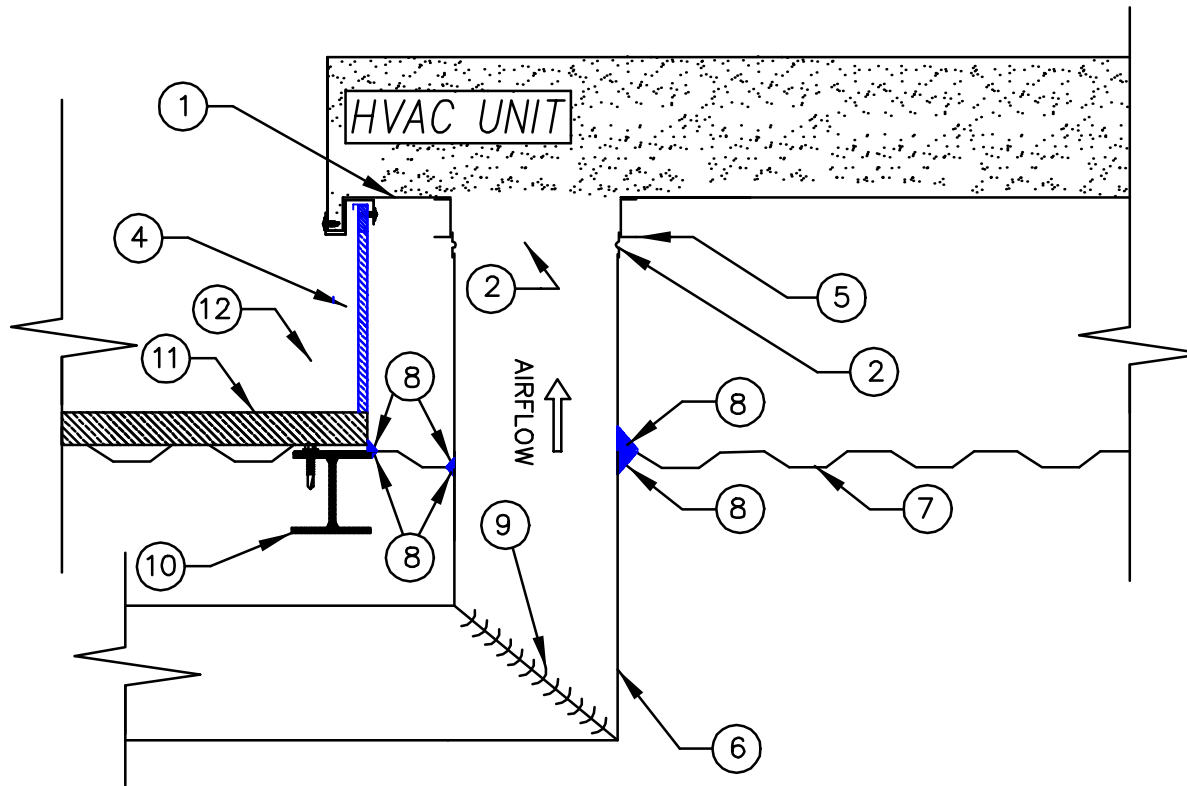

BY RTU UNIT MANUFACTURER

1. RTU BASE
2. RTU OPENING
3. RTU INTERNAL ISOLATION (NOT SHOWN)
4. BASE™ MODEL NIC NON-ISOLATED ROOF CURB
5. INTEGRAL CURB DUCT SUPPORT

BY HVAC CONTRACTOR

6. DUCT WORK
7. ROOF DECK FLASHED TO WITHIN 1/4" OF ALL DUCT DROPS BUT NOT IN CONTACT WITH DUCT WALL
8. HUSH SEALANT™ ACOUSTICAL GRADE CAULK AT ALL DUCT DROPS & CURB PERIMETER
9. TURNING VANE

BY GENERAL CONTRACTOR

10. BUILDING STEEL
11. BUILT-UP ROOF OR CONCRETE
12. INSULATION AND CANT STRIP

RTU CURB SYSTEM

HUSHCORE™ **BASE™** Model **NIC** shall be a fully assembled non-isolated curb system. The steel curb structural frame shall be 14 gauge G90 galvanized construction. The system shall be capable of serving as a blocking device during installation. All corners shall be mitered and welded. There shall be a 3" extended integral base plate. Wood nailer and flashing shall be provided and curbs shall be manufactured to NRCA Standards. The HUSH CURB™ shall be 14" high and shipped completely assembled. Products and systems shall be by BRD Noise and Vibration Control, Inc., Wind Gap, PA - (610) 863-6300, www.HUSHCORE.net