

HUSHCORE™ **BASE™** SYSTEM MODEL **HIC-2** INTEGRATED ONE PIECE VIBRATION ISOLATION CURB FOR ROOFTOP UNITS

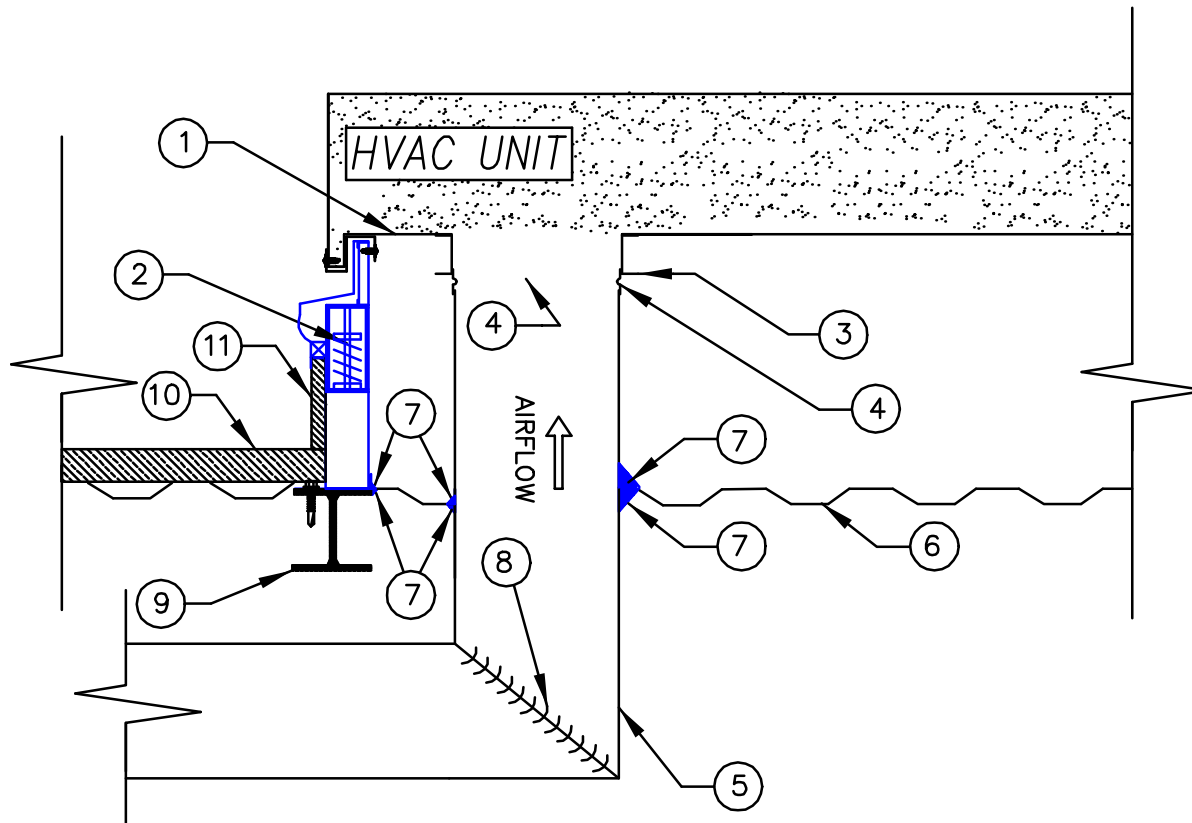

BY RTU UNIT MANUFACTURER

1. RTU BASE
2. BASE™ MODEL HIC-2 VIBRATION ISOLATION ROOF CURB
3. INTEGRAL CURB DUCT SUPPORT
4. RTU OPENING

BY HVAC CONTRACTOR

5. DUCT WORK
6. ROOF DECK FLASHED TO WITHIN 1/4" OF ALL DUCT DROPS BUT NOT IN CONTACT WITH DUCT WALL
7. HUSH SEALANT™ ACOUSTICAL GRADE CAULK AT ALL DUCT DROPS & CURB PERIMETER
8. TURNING VANE

BY GENERAL CONTRACTOR

9. BUILDING STEEL
10. BUILT-UP ROOF OR CONCRETE
11. INSULATION AND CANT STRIP

RTU NOISE REDUCTION SYSTEM

HUSHCORE™ **BASE™** System Model **HIC-2** shall be a 2" deflection, fully adjustable and fully assembled curb system. The completely isolated top and bottom steel structural frames shall have a continuous flexible weatherseal in between. The system shall be capable of serving as a blocking device during installation. The springs shall have built-in limit stops to snub out wind resistance. Model **HSIC-2** incorporates seismic construction. The HUSH CURB™ shall be 24" high and shipped completely assembled. There shall be removable access ports at each isolator location. Factory curbs with a secondary vibration rail kit are not acceptable. Products and systems shall be by BRD Noise and Vibration Control, Inc., Wind Gap, PA - (610) 863-6300, www.HUSHCORE.net

PERFORMANCE

The HUSH CURB™ shall provide minimum 85% vibration isolation efficiency.